



The conveyors with the pitch of the hinged belt link – 100 are designed for industrial heavy use and are therefore suitable for conveying of heavy swarf load. Primarily the repose angle of the discharge end of the conveyor is either 30°, 45° or 60°. Other repose angle has to be consulted with the conveyor manufacturer.

Technical specification of industrial operating procedures:

Carrying velocities for chip conveying of CDT 040, 063 and 100 range from 1 m/min up to 10 m/min

Load carrying capacity:

- CDT 100 up to 20 m³/hour (Approx. up to 10 tonnes/hour of assorted chips)

Technical description:

- A - Width of the case
- B - Width of the loading section of the conveyor
- C - Width of the hinged link
- Proportions of the hopper are optional
- Dimensions L, L₁, L₂ and L₃ conforming to customer's requirements
- We recommend the angle α to an extent of 60° in exceptional cases max. 70°
- The motor drive of the conveyor is situated in line with the direction of forward momentum of the chips. P on the right hand side, L on the left hand side
- For longer wear life of a conveyor we advise reinforcement of the case and the belt with HARDOX- hardened wear resistant steel plate.

t=100

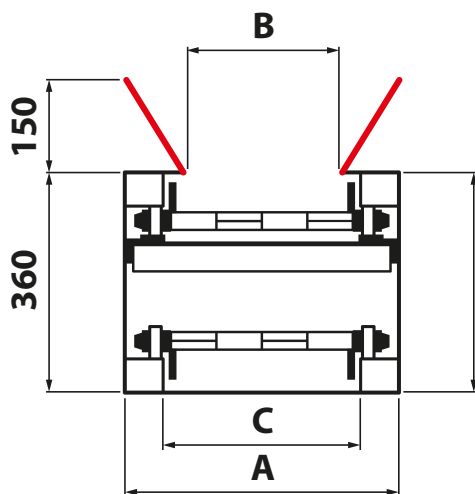

steep 2 angle conveyor

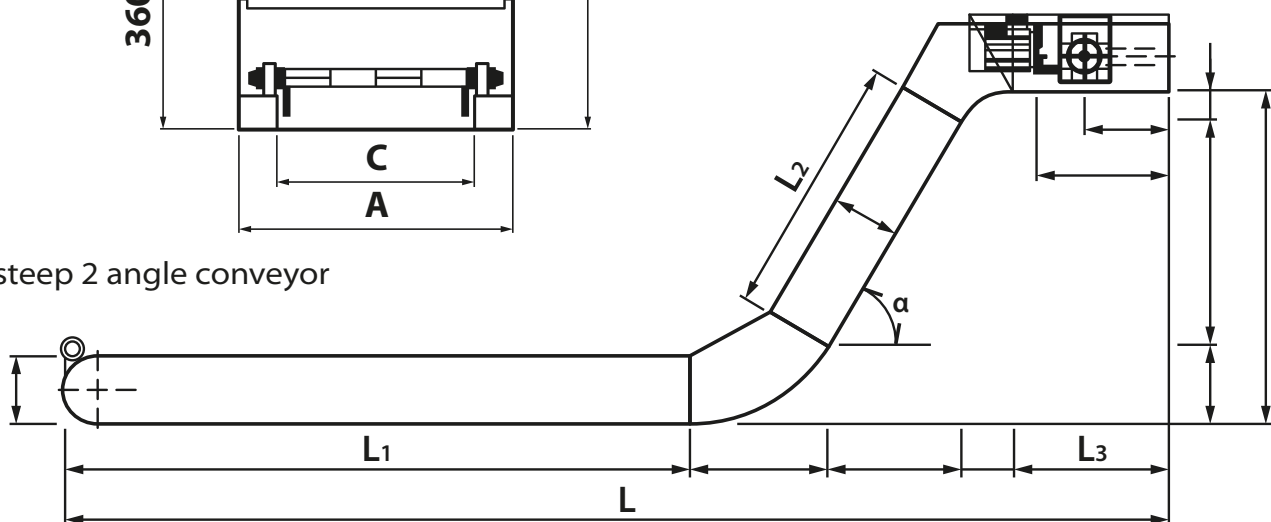

Typ	A	B	C
CDT 300	450	262	300
CDT 375	525	337	375
CDT 450	600	412	450

Typ	A	B	C
CDT 525	675	487	525
CDT 600	750	562	600
CDT 675	825	637	675

Typ	A	B	C
CDT 750	900	712	750
CDT 825	975	787	825
CDT 900	1050	862	900